



Alexander & Bishop Ltd is proud to present the Quail Run Farm community. This 40- acre lifestyle development at the west entry of Oshkosh is located minutes from area schools, retail stores, and restaurants. But more than a prime location, Quail Run is a way of life, catering to the individual in search of a quiet country atmosphere in a professional community. Alexander & Bishop invites you to call us today to talk about your new home at Quail Run Farms.



ALEXANDER & BISHOP, LTD.

300 North Main Street - Oshkosh, WI 54901
Phone: (920) 233 - 7219 ex.18 - Fax: (920) 235 - 2290

Come Home

To the serenity of your very own country manor without sacrificing the conveniences of city living



"An Estate Community"

www.alexanderbishop.com/quailrun

Community Location

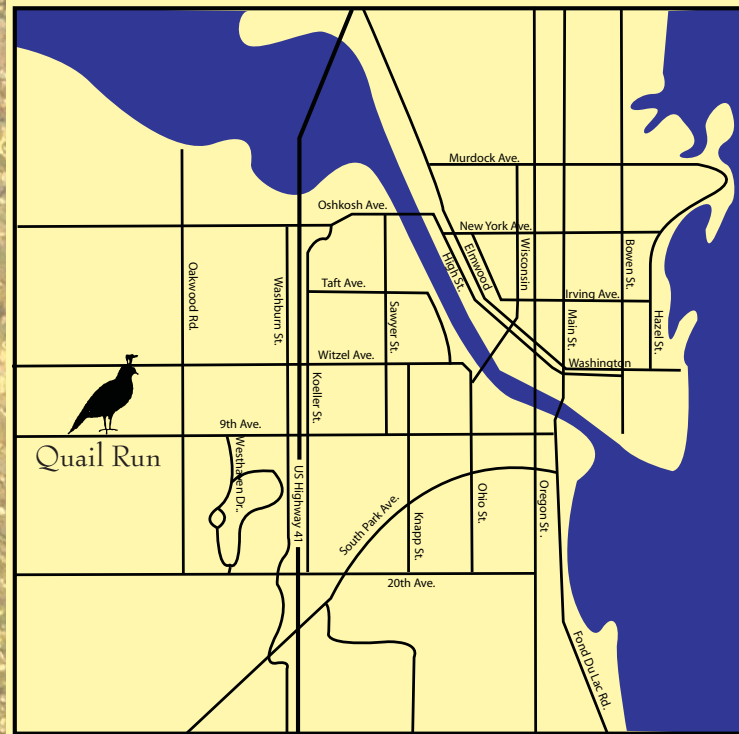

Located on the west side of Oshkosh, Quail Run Farm is a residential community designed for the homeowner who is looking for quiet country charm in a lifestyle community.

We hope you enjoy the serenity and elegance of Quail Run, as well as our efforts to provide you with a gracious environment in which to build your new home.

For more information on Quail Run Farm please contact:

Peter Jungbacker

Phone - (920) 233 - 7219 ex. 18

Email - pjungbacker@alexanderbishop.com

Site Plan

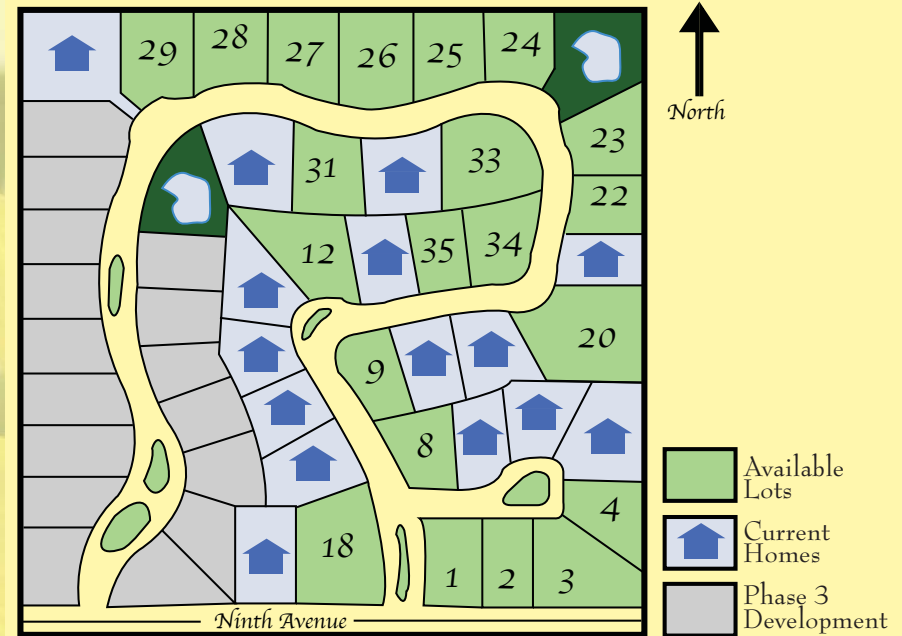

Neighborhood Standards

Each homesite at Quail Run Farm is subject to Homeowners Association and Architectural Review Committee Community standards which include:

- Generous setback from property lines
- Minimum residence size of 3,000 square feet
- 2-story residential design
- Natural wood, brick or stone exterior building components
- Garages with side driveway entry
- Swimming pools in-ground
- Outside storage of recreational equipment restricted

Quail Run

Home Site	Sq/Ft	Price
1	25,100	\$ 85,000
2	24,000	85,000
3	38,312	99,000
4	24,200	82,500
5	32,171	Sold
6	23,636	Sold
7	22,618	Sold
8	23,905	82,500
9	21,565	82,500
10	24,134	Sold
11	21,792	Sold
12	31,398	110,000
13	26,531	Sold
14	21,990	Sold
15	18,731	Sold
16	34,184	Sold
18	38,529	99,000
19	28,112	Sold
20	46,886	120,000
21	22,615	Sold
22	21,880	89,900
23	28,702	95,000
24	23,966	89,900
25	28,197	95,000
26	31,384	99,900
27	29,010	95,000
28	25,871	89,900
29	32,870	99,900
30	31,769	Sold
31	30,417	99,900
32	29,761	Sold
33	29,927	95,000
34	23,253	89,900
35	21,463	89,900